

Instructions

# Even Better Access panel

## Installation instructions

The Even Better Access Panel can be installed directly on to a Drywall Suspension Grid or a drywall or solid substrate, both with Even Better 25 mm (1") and Even Better 39 mm (1.5"). This provides four different installation alternatives; see the drawing below. Carefully study the drawings to determine whether the panel will be installed directly against the ceiling grid or will be secured in the ceiling grid through the GWB behind. Note that the supplied Z-plates are only used in installation alternative 1, Even Better 25 mm (1"), directly against the ceiling grid. Ensure to use the shim plates provided to adjust/lower access panel as needed.

25 mm (1") Acoustical Board Direct to Grid Even Better Access Panel

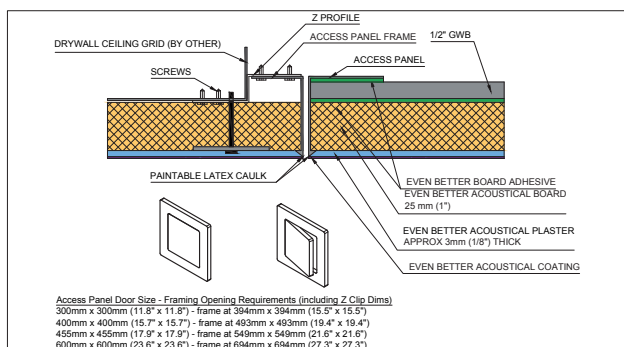

39 mm (1.5") Acoustical Board Direct to Grid Even Better Access Panel

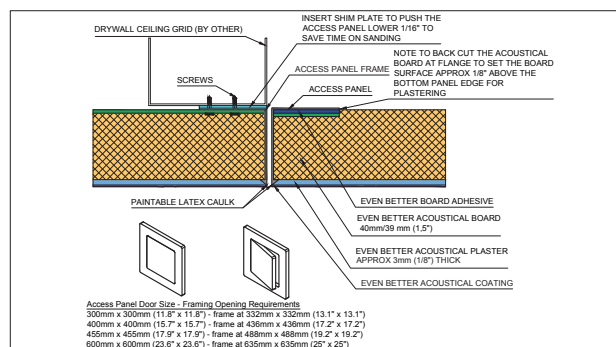

25 mm (1") Acoustical Board Direct to GWB Even Better Access Panel

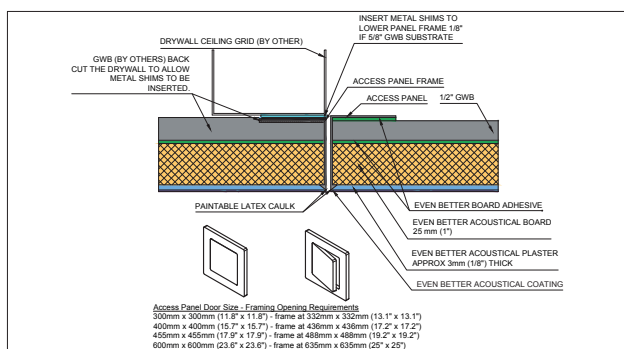

39 mm (1.5") Acoustical Board Direct to GWB Even Better Access Panel

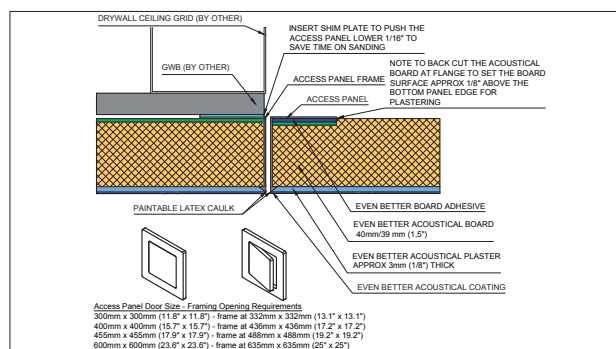

## Instructions

# Even Better Access panel

### Installation as follows:

1. Separate the access panel and frame. Inspect the framed opening to ensure correct dimensions as per the detail. Install the frame on to the ceiling grid with the supplied screws. Use the installation drawings to determine whether or not there will be a layer of drywall inside the panel.
2. Fit the absorbent sheet and any plaster spacers behind in the panel using construction glue (for Even Better 25 mm) and mechanically fasten with Fellert spring washers and screws (For Even Better 39 mm). Pre-seal the joint between the absorbent sheet and panel edge with paintable latex caulk. Let it dry per the manufacturer's instructions. When adhering the panels into the access panel ensure they are properly dried and adhered prior to installing into the door frame. Also Ensure to backcut the board at framing edge to recess the board at surface to allow for 1/8" plaster
3. Fit the absorbent sheet in the surrounding ceiling per Fellert's installation instructions. Pre-seal the joint between the absorbent sheet and panel frame with latex caulk. Let it dry per the manufacturer's instructions.
4. Test install the panel to ensure a good fit and ensuring the access panel functions properly in the provided framed opening.
5. Apply Even Better Plasters per Fellert's instructions. Keep the prefinished surfaces of the frame and panel masked during application, alternatively wipe with a clean cloth so that no plaster fastens on the frame's or panel's prefinished components. Keep access panel in place in the ceiling and spray plaster as per normal. Remove masking when complete.
6. Final step is attachment of the safety wire.

### Storage

Store in enclosed environment. Keep the Even Better Access Panels in their boxes until they are to be installed.

